

MATERIALS KEY

	HARD LANDSCAPING - SURFACE 1 - Tarmacadam • To Engineers specifications. • Used for vehicular surfaces.
	HARD LANDSCAPING - SURFACE 2 - Formed Concrete • To Engineers specifications. • Used for pedestrian areas only.
	HARD LANDSCAPING - SURFACE 3 - In situ synthetic surface • To Engineers specifications. • Colours to be agreed with Landscape Architect.
	HARD LANDSCAPING - SURFACE 4 - Block Paving • 6 inch x 60mm block paving in light grey colour, with charcoal border. • Or similar and approved.
	HARD LANDSCAPING - SURFACE 5 - Block Paving • 200x100x60mm block paving in light grey colour, with charcoal border. • Or similar and approved.
	HARD LANDSCAPING - SURFACE 6 - Reconstituted Granite Flag Paving • 600x300x50mm silver granite. • Sample to be provided for approval.
	HARD LANDSCAPING - SURFACE 8 - Hoggin • Hoggin surface for school garden area.
	HARD LANDSCAPING - TREE GRILLE • Square tree grille. • Cast Iron, 1150mm square, 450mm diameter bore.
	HARD LANDSCAPING - FENCE 1 • As per Architects specifications. • 1.2m high Anti-climb low top fencing or similar and approved.
	HARD LANDSCAPING - FENCE 2 • As per Architects specifications. • 1.8m high secure fencing.
	HARD LANDSCAPING - FENCE 3 • As per Architects specifications. • 2.4m high Palatin fencing.
	HARD LANDSCAPING - SEAT 1 • Recycled plastic picnic table. • Black, surface mounted, 1500 (l) x 450 (w). • Installed to manufacturers recommendations.
	HARD LANDSCAPING - SEAT 2 • Recycled plastic seat. • Green, red, and blue mixed, surface mounted, 1800 (l) x 360 (w). • Installed to manufacturers recommendations.
	HARD LANDSCAPING - SCHOOL GARDEN • Hoggin surface. • Enclosed by 1.2m height anti-climb low top fencing and entry gate. • School garden illustrates recommended elements such as potting shed with guttering, water butts, raised veg/herb beds and composters.
TREE PLANTING: NO TREES WITHIN 7M OF LAMP STANDARDS OR 2.5M OF SERVICES. PLANTING DISTANCES BETWEEN LANDSCAPING AND UNDERGROUND SERVICES (WATER MAINS / SURFACE FOU) TO BE IN ACCORDANCE WITH THE STANDARD DETAILS AND CODES OF PRACTICE FOR LANDSCAPING. ROOT PROTECTION BARRIER TO BE INSTALLED IF REQUIRED.	
	SOFT LANDSCAPING - TREE 1 (indicated tree indicates growth after 10 years) • Multistem White European Birch • Betula utilis var. jacquemontii - multistem, 3.5m height. • To be underground guyed. See Detail D07 on 142_EN_DD_02.
	SOFT LANDSCAPING - TREE 2 (indicated tree indicates growth after 10 years) • Amelanchier canadensis - multistem, 3m height, CG. • To be underground guyed. See Detail D07 on 142_EN_DD_02.
	SOFT LANDSCAPING - TREE 3 (indicated tree indicates growth after 10 years) • River Birch • Native Spade - 3-3.5m ht, 16/18cm grth, CG. • To be double staked. See Detail D08 on 142_EN_DD_02.
	SOFT LANDSCAPING - TREE 4 (indicated tree indicates growth after 10 years) • Native Elm • Quercus robur - 16/18cm grth, CG. • To be double staked. See Detail D08 on 142-EN-DD-02.
	SOFT LANDSCAPING - TREE 5 (indicated tree indicates growth after 10 years) • Native Lime • Ficus cordata - 16/18cm grth, CG. • To be double staked. See Detail D08 on 142-EN-DD-02.
	SOFT LANDSCAPING - TREE 6 (indicated tree indicates growth after 10 years) • Native Spade Elm • Pinus sylvestris - feathered, 16/18cm grth, CG. • To be underground guyed. See Detail D07 on 142_EN_DD_02.
	SOFT LANDSCAPING - TREE 7 (indicated tree indicates growth after 10 years) • Acer campestre - Native Field Maple - 12/14cm grth, 25% • Euonymus europaeus - Native Spindle Tree - 12/14cm grth, 25% • Crataegus monogyna - Native Hawthorn - 12/14cm grth, 25% • Prunus padus - Native cherry - 12/14cm grth, 25% • To be single staked. See Detail D09 on 142_EN_DD_02.
	SOFT LANDSCAPING - TREE 8 (indicated tree indicates growth after 10 years) • Hornbeam • Carpinus betulus 'Fastigiata' - 18/20cm grth, 3m height, feathered cone. • To be underground guyed. See Detail D10 on 142_EN_DD_02.
	SOFT LANDSCAPING - HEDGE 1 - Internal Hedge To be planted at 6m, per lin. m, in a double staggered row, 400mm between rows. • Acer campestre - 60/120cm Ht. bt, 1+1, 15% • Betula pendula - 60/90cm Ht. bt, 1+1, 15% • Corylus avellana - 50/120cm Ht. bt, 1+1, 10% • Crataegus monogyna - 60/90cm Ht. bt, 1+1, 20% • Euonymus europaeus - 60/90cm Ht. bt, 1+1, 10% • Ilex aquifolium - 40/80cm Ht. CG, 3L, 10% • Prunus spinosa - 60/90cm Ht. bt, 1+1, 5% • Rosa rugosa 'Rubra' - 40/80cm Ht. 0+1, 5% • Albium oxalis - 40/80cm Ht. bt, 1+1, 5% See Detail D05 on 142_EN_DD_02. For trees at 10m intervals see Tree 7 above.
	SOFT LANDSCAPING - HEDGE 2 - Internal Hedge To be planted at 3m, per linear metre, in a single row. • Laurus nobilis (Bay), CG, 10L, minimum height of 1.75m. See Detail D06 on 142_EN_DD_02.
	SOFT LANDSCAPING - PLANT MIX 1 (600mm c/c) (4no. per sq.m.) To be finished with a 50mm layer of rounded pea gravel (4-6mm). Shrubs • Euonymus fortunei 'Silver Queen' - CG, 2L, 25% • Ilex cornuta 'Springwood White' - CG, 1.5L, 25% • Prunus 'Olio Lykens' - CG, 2L, 25% • Lavandula 'Hidote' - CG, 2L, 25% SUBSTITUTIONS TO BE CONFIRMED WITH LANDSCAPE ARCHITECT. See Detail D01 and D02 on Dwg. No. 142_EN_DD_02 for more information.
	SOFT LANDSCAPING - PLANT MIX 2 (600mm c/c) (2.78no. per sq.m.) To be finished with a 50mm layer of heavy grade bark mulch. Shrubs • Abelia grandiflora - CG, 3L, 10% • Aucuba japonica 'Rozanne' - CG, 3L, 10% • Choisya ternata 'Aztec Pearl' - CG, 3L, 10% • Cornus alba 'Winter White' - CG, 3L, 10% • Cornus 'Midwinter Magic' - CG, 3L, 10% • Fuchsia 'Riccarton' - CG, 3L, 10% • Ilex aquifolium - CG, 3L, 10% • Pittosporum 'Argyrophyllum' - CG, 11L, 10% • Rosa rugosa - CG, 2L, 10% • Albium 'Eye Pique' - CG, 5L, 10% SUBSTITUTIONS TO BE CONFIRMED WITH LANDSCAPE ARCHITECT. See Detail D01 and D02 on Dwg. No. 142_EN_DD_02 for more information.
	SOFT LANDSCAPING - PLANT MIX 3 (400mm c/c) (8.25no. per sq.m.) To be finished with a 50mm layer of rounded pea gravel (4-6mm). Area to include a water feature, sensory planting, and a bed table station. Perennials • Agapanthus 'Black Panther' - CG, 3L, 5% • Agapanthus 'Double Diamond' - CG, 3L, 5% • Anemone 'Soleil d'Or' - CG, 2L, 5% • Echinacea purpurea 'Magnus' - CG, 2L, 5% • Erythronium 'Emmer Green' - CG, 2L, 5% • French Cornflower - CG, 2L, 5% • Geranium 'Johnson's Blue' - CG, 3L, 5% • Helianthus 'Red Jewel' - CG, 3L, 5% • Monarda 'Fireball' - CG, 2L, 5% • Rudbeckia 'Goldstrum' - CG, 2L, 5% • Salvia 'Caradonna' - CG, 2L, 5% • Verbena bonariensis - CG, 2L, 5% Grasses • Pennisetum lessoniana - CG, 2L, 5% • Abelia nervosa 'Westland' - CG, 3L, 5% • Libertia exoniensis 'Summer Green' - CG, 2L, 5% • Miscanthus sinensis 'Kleine Silberspinne' - CG, 2L, 5% • Pennisetum 'Kinky-Rose' - CG, 3L, 5% • Stipa gigantea - CG, 2L, 5% SUBSTITUTIONS TO BE CONFIRMED WITH LANDSCAPE ARCHITECT. See Detail D01 and D04 on Dwg. No. 142_EN_DD_02 for more information.
	SOFT LANDSCAPING - PLANT MIX 4 (400mm c/c) (6.25no. per sq.m.) To be finished with a 50mm layer of rounded pea gravel (4-6mm). Area to include a water feature, sensory planting, and a bed table station. Perennials • Allium schoenoprasum - CG, P9, 10% • Erythronium 'Bowles Mauve' - CG, 3L, 10% • Lavandula 'Hidote' - CG, 2L, 10% • Nepeta 'Blue Carpet' - CG, 2L, 10% • Penstemon 'Little Spiglet' - CG, 2L, 10% • Rosmarinus officinalis 'Miss Jessop's Upright' - 3L, 10% • Salvia 'Sage' - CG, 2L, 10% • Stachys 'Byzantine' - CG, 2L, 10% • Thymus 'vulgaris' - CG, 2L, 10% • Verbena bonariensis - CG, 2L, 10% SUBSTITUTIONS TO BE CONFIRMED WITH LANDSCAPE ARCHITECT. See Detail D01 and D04 on Dwg. No. 142_EN_DD_02 for more information.
	SOFT LANDSCAPING - BULB PLANTING IN GRASS Bulbs to be incorporated at 30 bulbs per sq metre Mowing to be reduced in accordance with suppliers instructions. • Crocus 'Tommy Stainback' - 15% • Crocus 'Verano' - 15% • Crocus 'Verano' - 15% • Muscari 'aucherii' 'White Magic' - 5% • Narcissus 'Jack Snipe' - 15% • Narcissus recurvus - 15% • Narcissus 'W.P. Miller' - 15%
	SOFT LANDSCAPING - AMENITY GRASS Area to be cultivated and graded with the surface raked to a fine tilt, removing stones and debris. • Seeding with a hardwearing lawn seed mix to manufacturers recommendations.

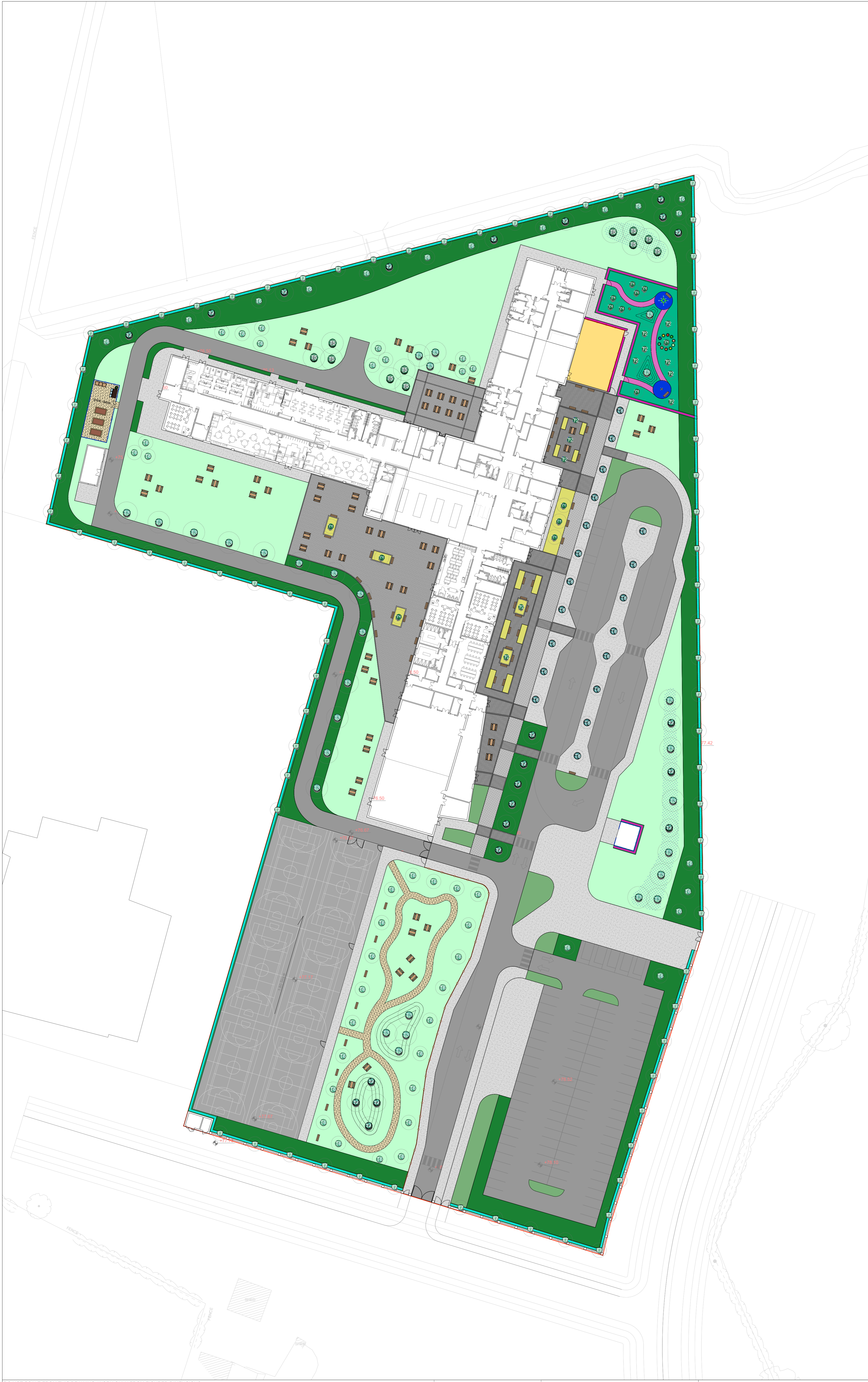

DO NOT SCALE FROM THIS DRAWING. WORK ONLY FROM FIGURED DIMENSIONS
ALL ERRORS AND OMISSIONS ARE TO BE REPORTED TO LANDSCAPE ARCHITECT

REV.	DATE	REFERENCE	BY	REV.	DATE	REFERENCE	BY
A	2020-05-25	LANDSCAPE DESIGN PLAN	KR				
B	2020-06-18	CHANGES REQUESTED BY DoES	KR				

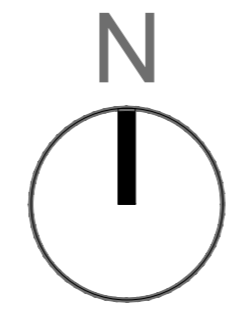

MURPHY+SHEANON
Horticulture & Landscape Architecture

Contact : colum@murphysheanon.ie
Tel : +353860787147
Address 2 Richmond Lodge, Richmond Green,
Carrickbrennan Road, Monkstown, Dublin .18

CLIENT: THE DEPARTMENT OF EDUCATION AND SKILLS	DRAWING NUMBER: 142-EN-DD-01
PROJECT: ENFIELD POST PRIMARY SCHOOL, COUNTY MEATH.	PROJECT NUMBER: 142 EN
TITLE: LANDSCAPE DESIGN PLAN	PROJECT STATUS: PLANNING
	SHEET NO: B
	DATE: JUNE 2020
	SCALE: 1:500@A1
	DRAWN BY: KR
	CHECKED BY: DM/CS

CAD FILE REFERENCE:
g:\shared drives\murphy sheanon office\m+s_office\jobs\1701142 - rapid schools\projects\2020 bundle\07_enfield\04_planning\142-en-dd-01_18.06.20.dwg